

SLOT CHANNELS



ADVANTAGES

- good match to the interior design,
- cheaper option in comparison to standard drainage channels,
- possible connection to other channel types,
- grating is not required,
- easy installation.

A cheap and simple method for draining the surfaces where high flow capacity is not required. A perfect solution for rooms with condensate dripping from machinery or A/C systems: bakeries, dairies and swimming pools, as a separation of wet and dry areas.

MANUFACTURING TECHNOLOGY

The slot drainage channels are made of 1.5-2 [mm] sheets. They feature inclination and can be adapted to the floor thickness. Water drainage from the slot channel can be via a stub pipe or the trapped floor drain with a waste basket. Standard length of a channel with a single outlet should not exceed 10 [m]. The channel sections exceeding 4 [m] in length are joined by means of flanges with gaskets.

SLOT CHANNELS

MINI SLOT CHANNEL

The mini slot channels are made of the 2 [mm] sheet. The channel is not covered with any grating. It has smaller inlet opening and clearance. It is used in the places where smaller amount of water need to be drained.

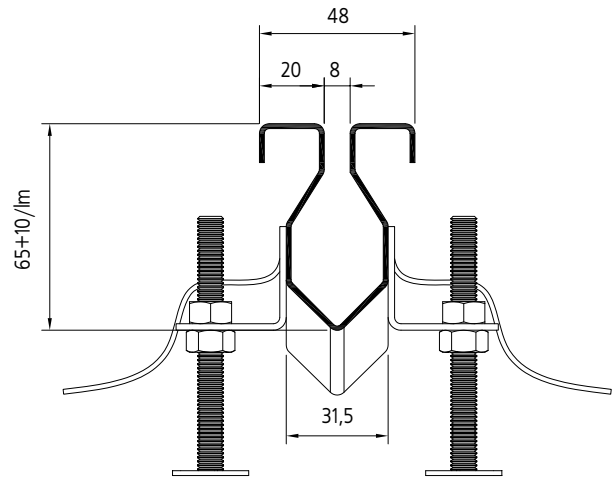

Mini slot channel

MAXI SLOT CHANNELS

The maxi slot channels are made of the 2 [mm] sheet. This channel does not require grating and features higher flow capacity than standard channels. One of its characteristic features is larger inlet opening and clearance. Used wherever the amount of wastewater to be drained is substantial and standard channel does not need to be used due to the production process requirements (absence of large solids).

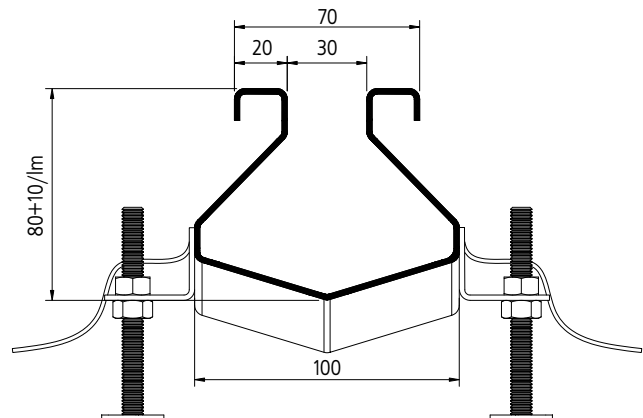

Maxi slot channel

STANDARD MINI CHANNEL

The standard mini channel combines the advantages of the standard and slot channels. It has small dimensions and features gratings. These channel types are used wherever the amount of water to be drained is small, but the rodding eye is necessary. As a standard, such channels are made of 1.5-2 [mm] V2A or V4A sheets.

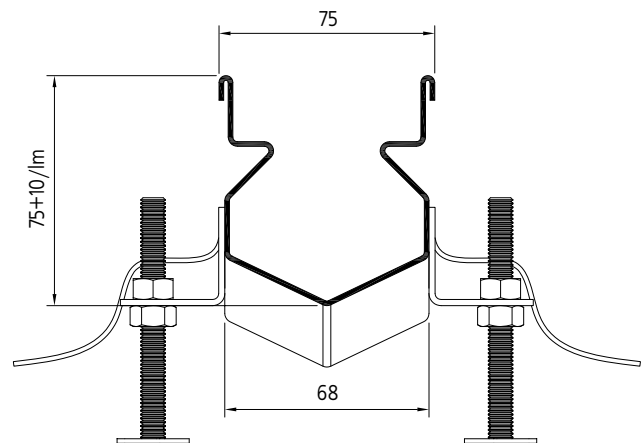

Standard mini channel